

# Fitting Instructions for Mirror Covers with Indicator Repeaters.

1) Lower the windows and remove the door panels.

1. Remove the screw.
2. Remove the inner handle cover.
3. Remove the fasteners.
4. Pull the door trim, then disengage clips **A** and **B** from the body.
5. Lift the door trim, then disengage tabs **C** and **D** from the body.

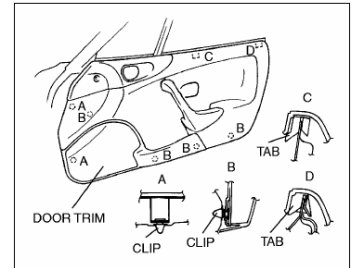
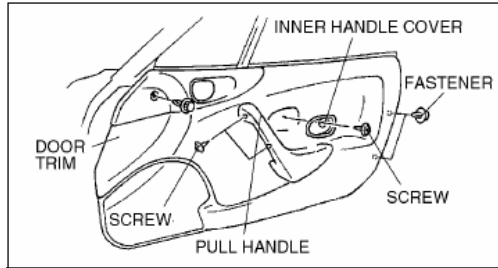

2) Remove the door speakers.

3) Using the supplied template, mark the back of the mirror and drill a 4mm hole. (It is possible to fit the covers without drilling, but the result is not as neat).



4) Disconnect the Battery. (make sure you know the radio code first if applicable!).

5) Remove the outer side interior footwell trim.

6) Remove the mirror glass.

1. Put on gloves and safety glasses.
2. Push the top of the mirror glass. (1)
3. Pull the bottom of the mirror glass to disengage clips and remove the mirror glass holder with the mirror glass from the frame. (2)

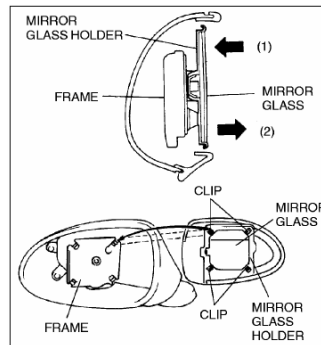

7) Feed the wire through the hole in the back of the mirror and down through the central fixing of the mirror body to the door so that the wire is exposed inside the door.

8) Clean the body of the mirror thoroughly and stick the cover to the mirror and re-fit the mirror glass.

1. Insert the bottom of the mirror glass holder with the mirror glass into the frame to install the lower clips. (1)
2. Press the top of the mirror glass holder with the mirror glass onto the frame to install the upper clips. (2)

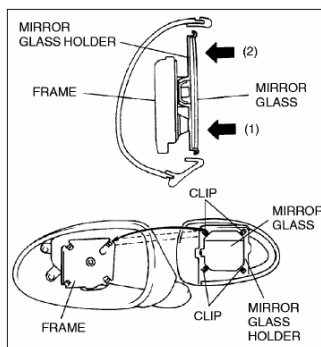

9) Remove the door (2 people required). Note: 2 of the bolts have shoulders and locate onto the washers that are spot welded to the hinge. (It is possible to install without following the next procedures, simply by passing the wire in a loop from the door to the 'A' pillar but the result will not be very professional as the wire will remain exposed).

Disconnect the wiring plug (1) by first pulling the Green PIN out.  
 Remove the Check Strap roll pin (2)  
 Remove the 4 hinge bolts (hinge to door) (3)  
 (14mm heads)  
 Lift the door away from the body and carefully place upright on the floor.

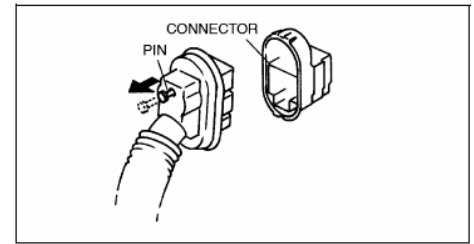
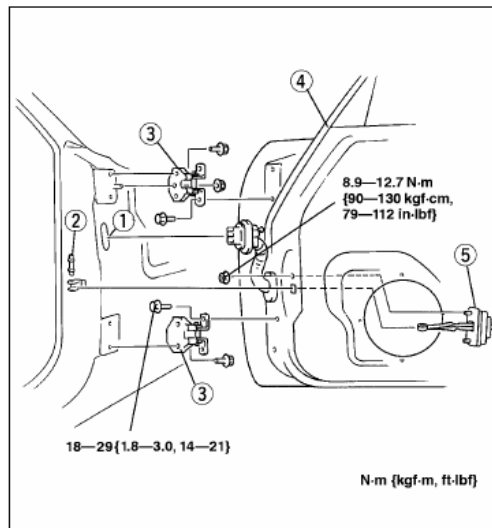

10) Drill the Door plug and Body socket with a 3mm drill in the location indicated in the picture below.



- 11) Feed the mirror wire through the door plug and body socket.
- 12) Re-fit the door and check strap roll pin. No adjustment of the door should be necessary ☺.
- 13) Repeat all of the above on the other door ☺.
- 14) Remove the cover under the steering column (2 screws).
- 15) Remove the glovebox and feed the mirror wire across to the driver's side. Re-fit the glovebox.

- 16) Locate the black electrical connector block mounted under the steering column (this takes all the column switch wires).
- 17) Locate the green/black stripe wire (left hand indicator). Connect the Black/white stripe wire from the left hand mirror cover using a connector block.
- 18) Locate the Green/White stripe wire (right hand indicator). Connect the Black/white stripe wire from the right hand mirror cover using a connector block.

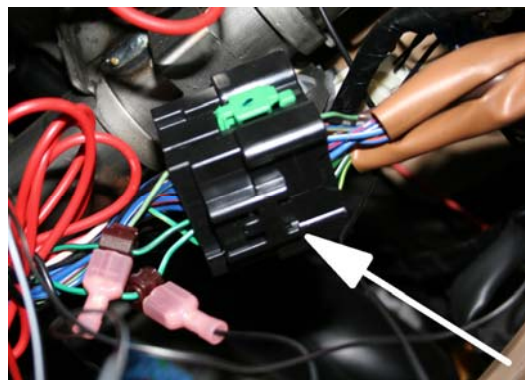

- 19) The two Black wires from the mirror covers mount to a good earth point.
- 20) Re-connect the battery and check that all the indicators work correctly.
- 21) Re-fit all interior trim panels etc.
- 22) Stand back and admire your handywork ☺

Scimitar International Ltd.  
 Cluster Industrial Estate  
 Rodney Road, Portsmouth  
 Hampshire, PO48ST  
 Tel: 0845 345 2384 Fax: 0845 345 2385  
 Website: <http://www.mx5parts.co.uk>

© Copyright 2006, Scimitar International Ltd.