

mods4cars

INSTALLATION

smartTOP



STHFMA1

Comfort Roof Control Module for

- Mazda MX-5 PRHT

v1.0

Further information and manuals for all products can be found on our web site

www.mods4cars.com

We explicitly point out that all functions of this control unit should only be used while exercising caution and responsibility. We can NOT be held liable for any damage or injury caused by installing or using this product. PLEASE READ THE COMPLETE MANUAL CAREFULLY BEFORE USING THIS PRODUCT.

Installation - Important Information



This module comes with our **USB Field Upgrade and Configuration Port!** BEFORE YOU INSTALL, we encourage you to connect the module using the supplied USB cable and check for firmware updates. All information and software regarding this new feature can be found at www.mods4cars.com/usb. You can even configure and activate your favorite module functions and settings on screen before the module is installed in the car! It is also possible to permanently install the USB cable with the module in the car, leaving the PC end in an easily accessible spot for later use with a Wifi laptop.

The green InstallAID™ LED signals a correct installation and shows the status of the module.

LED OFF

- Ignition OFF: CAN bus and module are in low-power standby mode. This is normal.
- Ignition ON: Either power connection or CAN bus connection is interrupted. Check the two wire taps for power and ground as well as the CAN connectors. Also make sure the CAN polarity is correct.

LED either dimly lit or flickering erratically

- A dim or flickering LED is an indicator for interrupted or missing POWER or GROUND connections. The module will get some leakage current from the CAN bus which causes the LED to stay dimly lit or flicker erratically. See previous paragraph about t-taps!

LED permanently ON

- Module is connected to CAN and power, but does not receive the correct data. Recheck all connections thoroughly. A VERY COMMON source of problems is reversed polarity on the CAN wires. Double-check the POLARITY and wire-colors of all connections!

LED blinks

- CAN bus is active, the module is connected correctly and ready for use.

S/N < xxx-090501-xxx

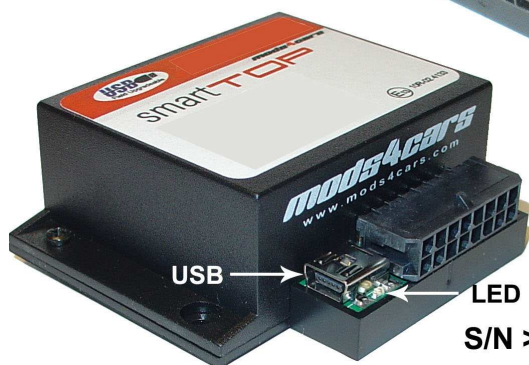
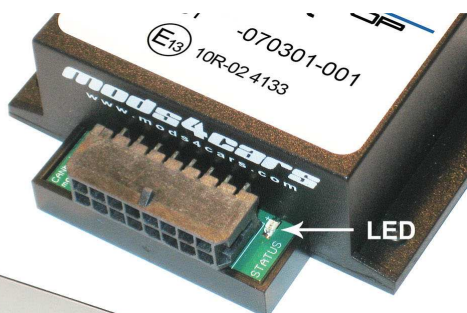

S/N > xxx-090501-xxx

Installation - Steps 1-3



1. Open the convertible top for better access. **IMPORTANT: Turn off ignition and pull key out before continuing!** Open the cover behind the driver's seat (left side of the car) as shown. Use a flat screw driver or any flat object like a coin to pry it out on the top.

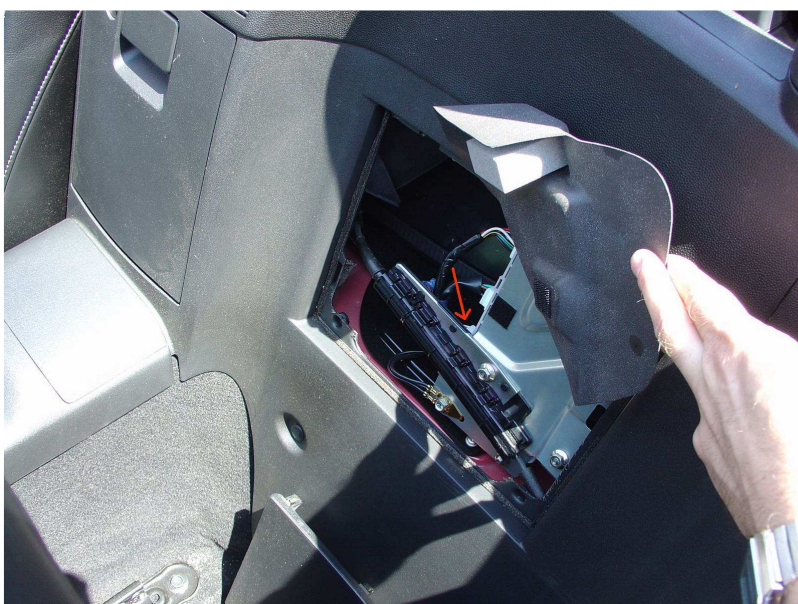

2. Lift up the padding to reveal the convertible top controller. The bottom plug (marked with the arrow) will have to be removed in the next step.

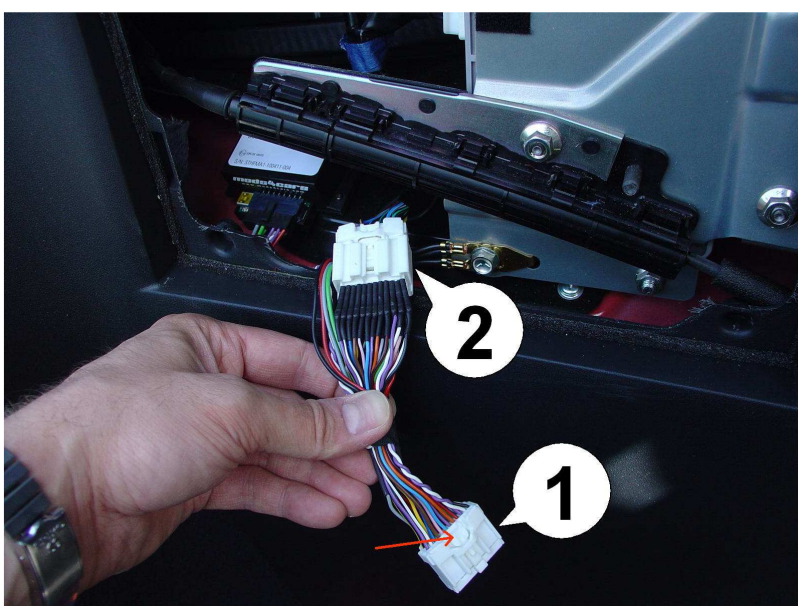

3. For better visualization the locking mechanism is shown on the smartTOP plug (1), marked with an arrow. It needs to be pushed down while pulling hard on the plug. Once the plug is out, plug it into the matching socket on the smartTOP wiring harness (2).

Installation - Step 4

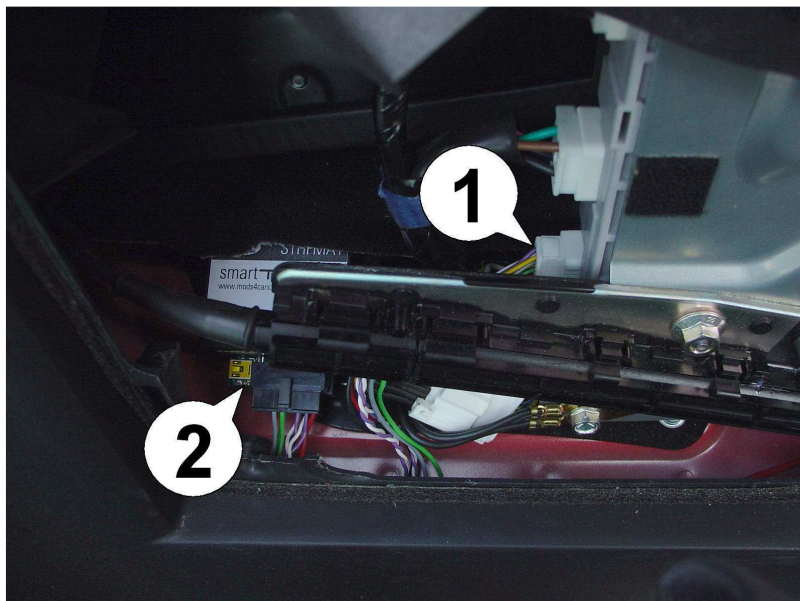

4. Connect the smartTOP plug (1) to the top controller, then connect the smartTOP module to the harness. Turn the ignition on. A rapidly blinking green LED (2) will indicate proper installation. Lastly, program the module as desired, according to the operation manual.